

FRONT ELEVATION

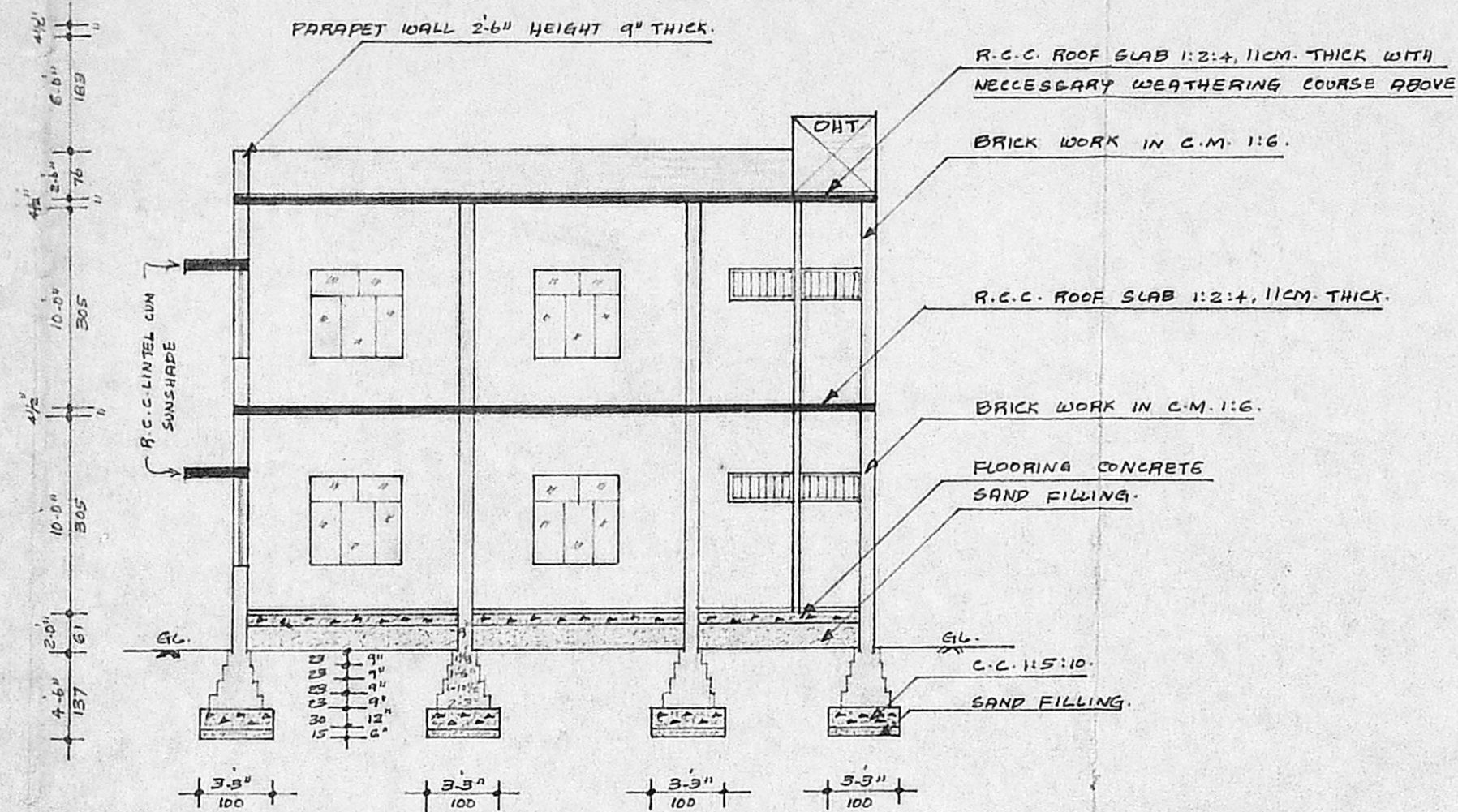

SECTION ON 'A-B'

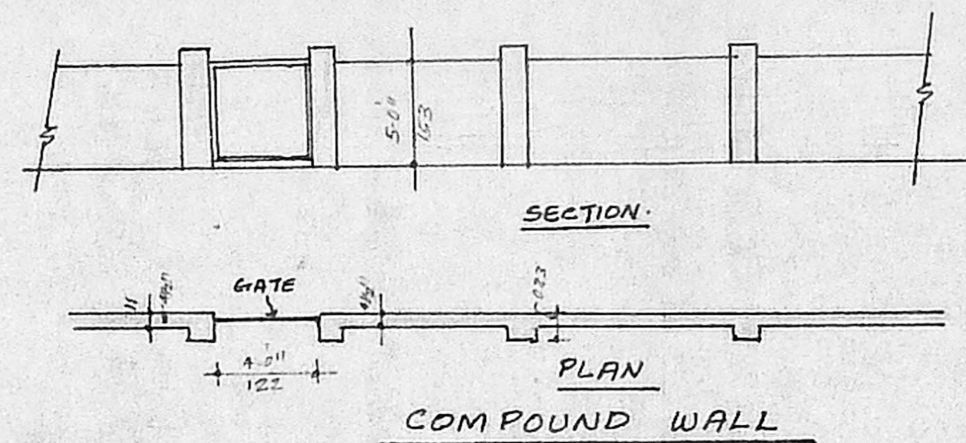

PLAN
COMPOUND WALL

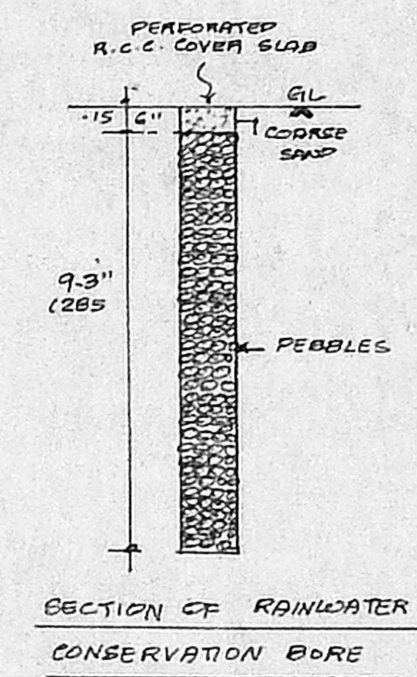

SECTION OF RAINWATER
CONSERVATION BORE

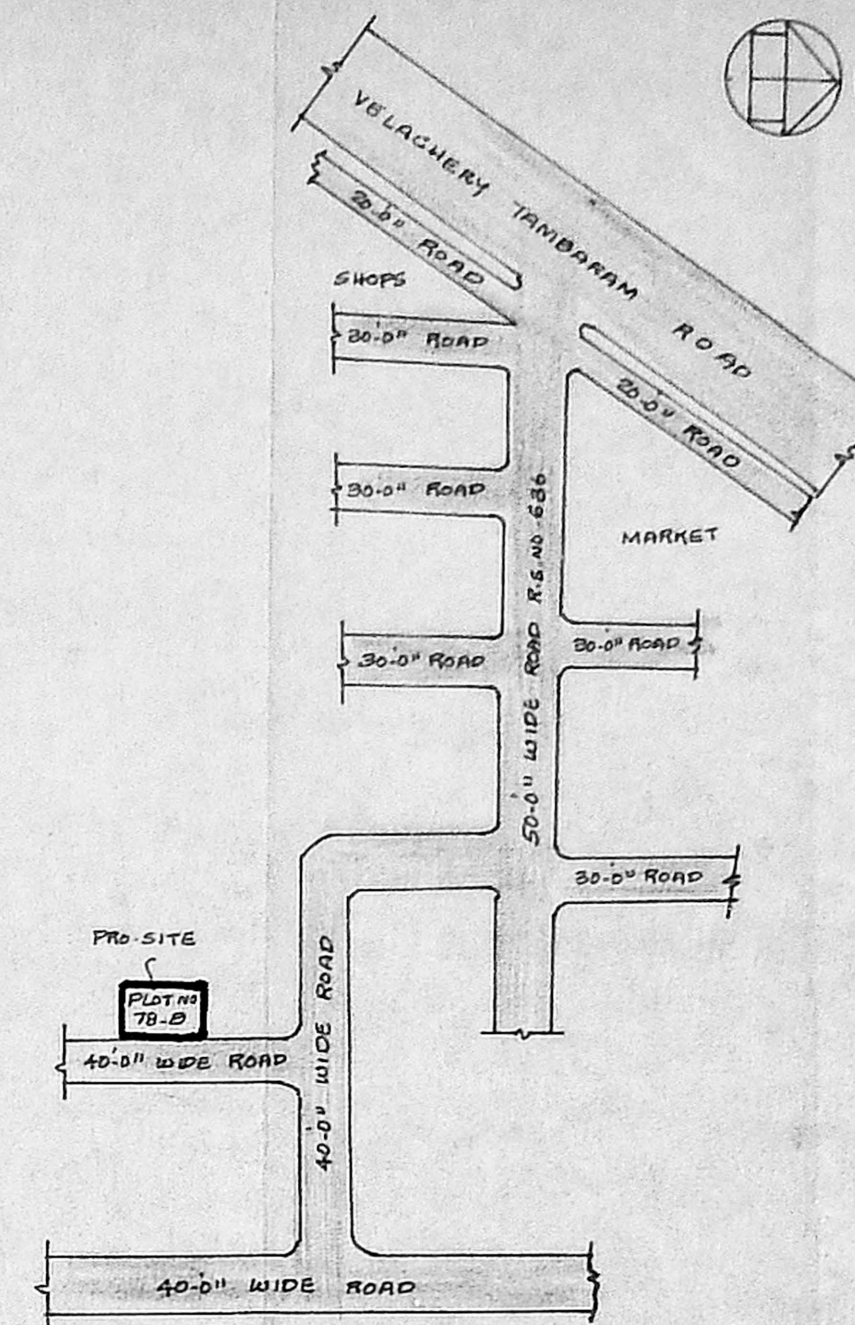

KEY PLAN (not to scale)

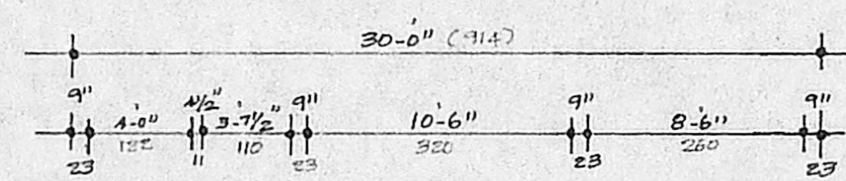
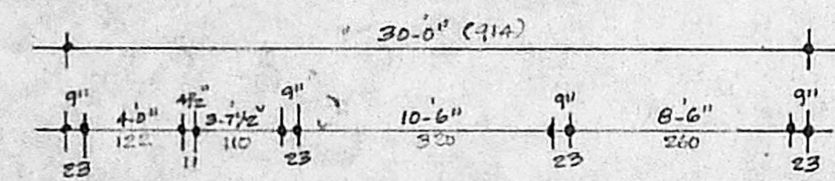

A/20280/166/96
APPROVED
 SUBJECT TO THE CONDITIONS IN
 THIS OFFICE LETTER.
 No. A/156/96 Dtd. 5.5.96
 o/c S. Jey
 FOR MEMBER SECRETARY
 MADRAS METROPOLITAN
 DEVELOPMENT AUTHORITY
 MADRAS - 600 008.

H. 30/9
 3/15

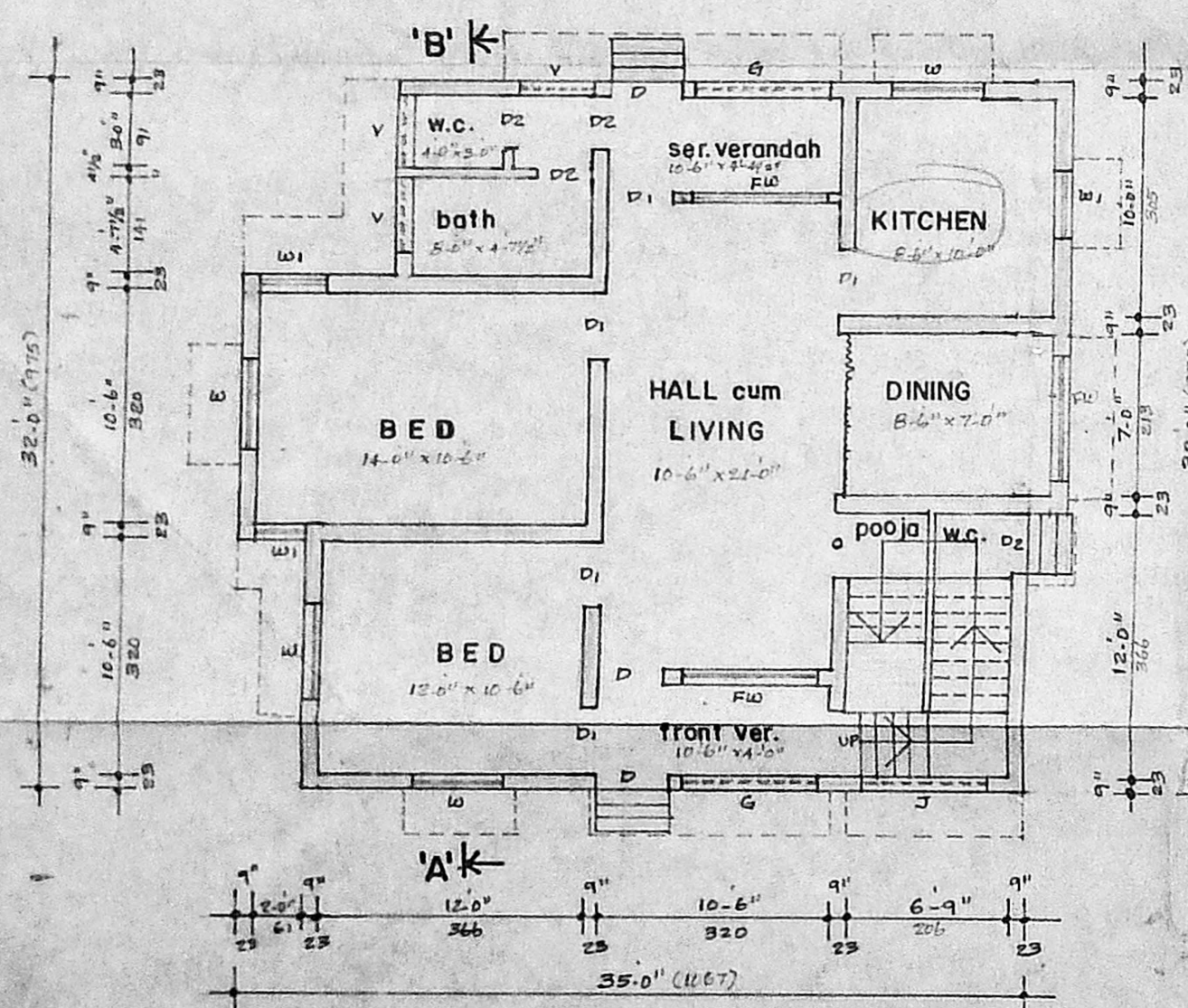

PRO. GROUND FLOOR PLAN

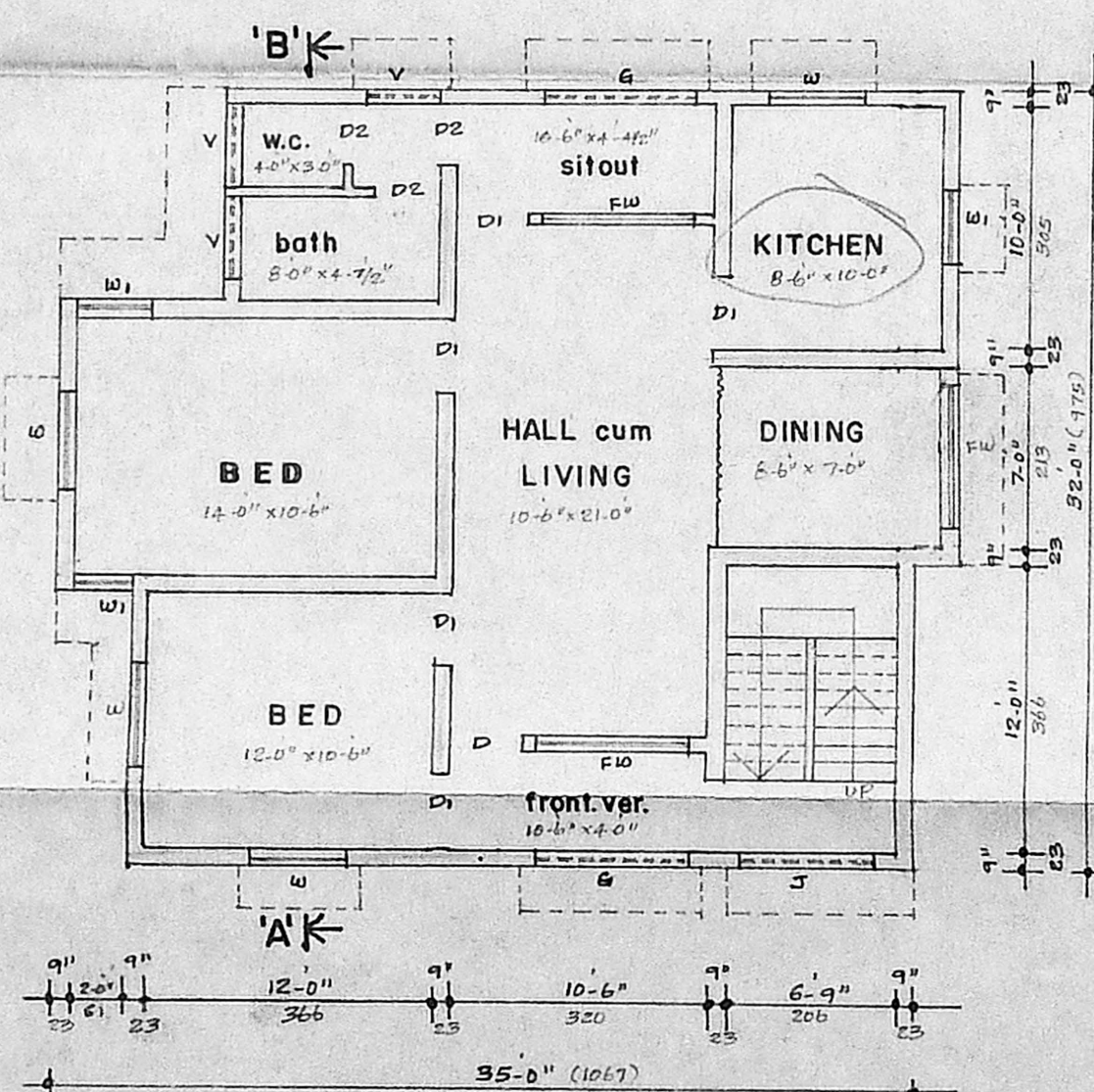

PRO. FIRST FLOOR PLAN

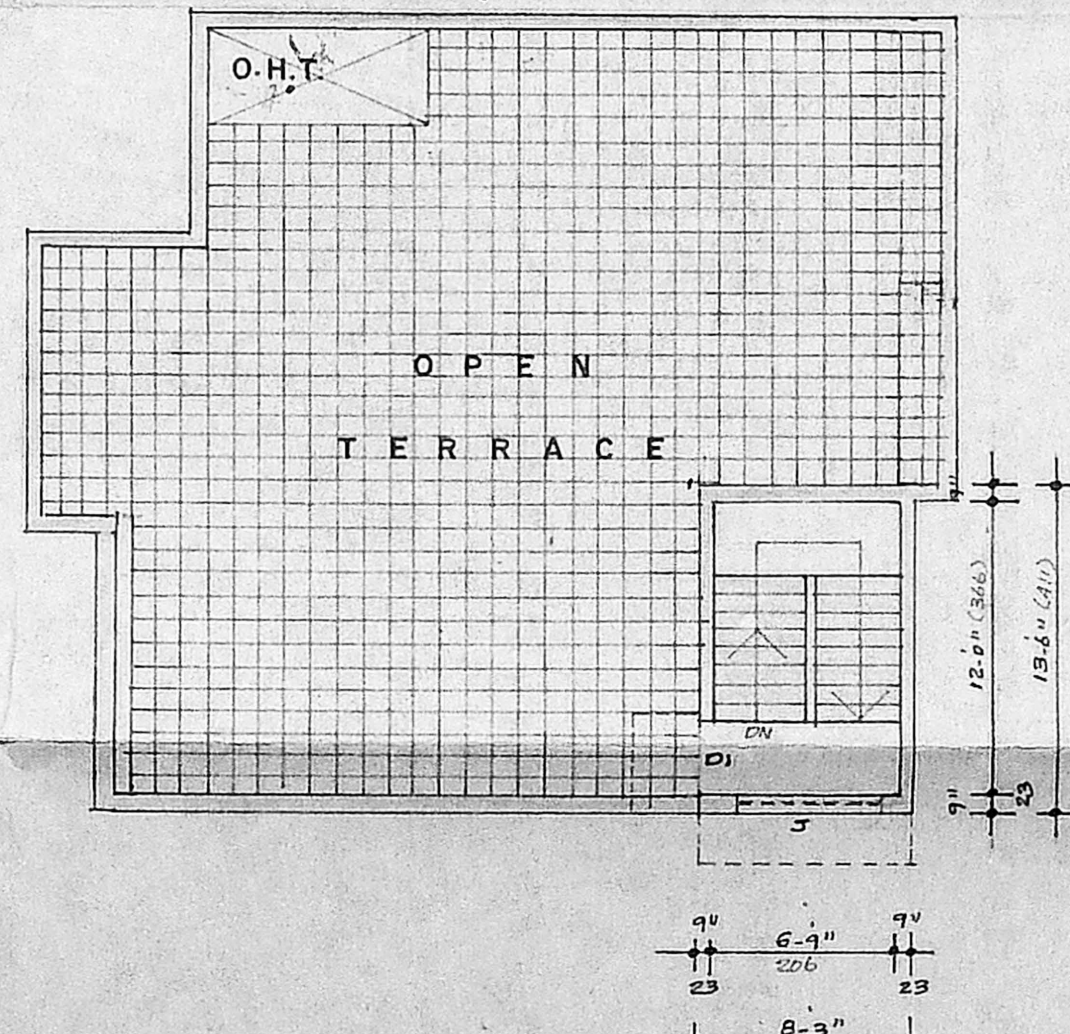

PRO. TERRACE FLOOR PLAN

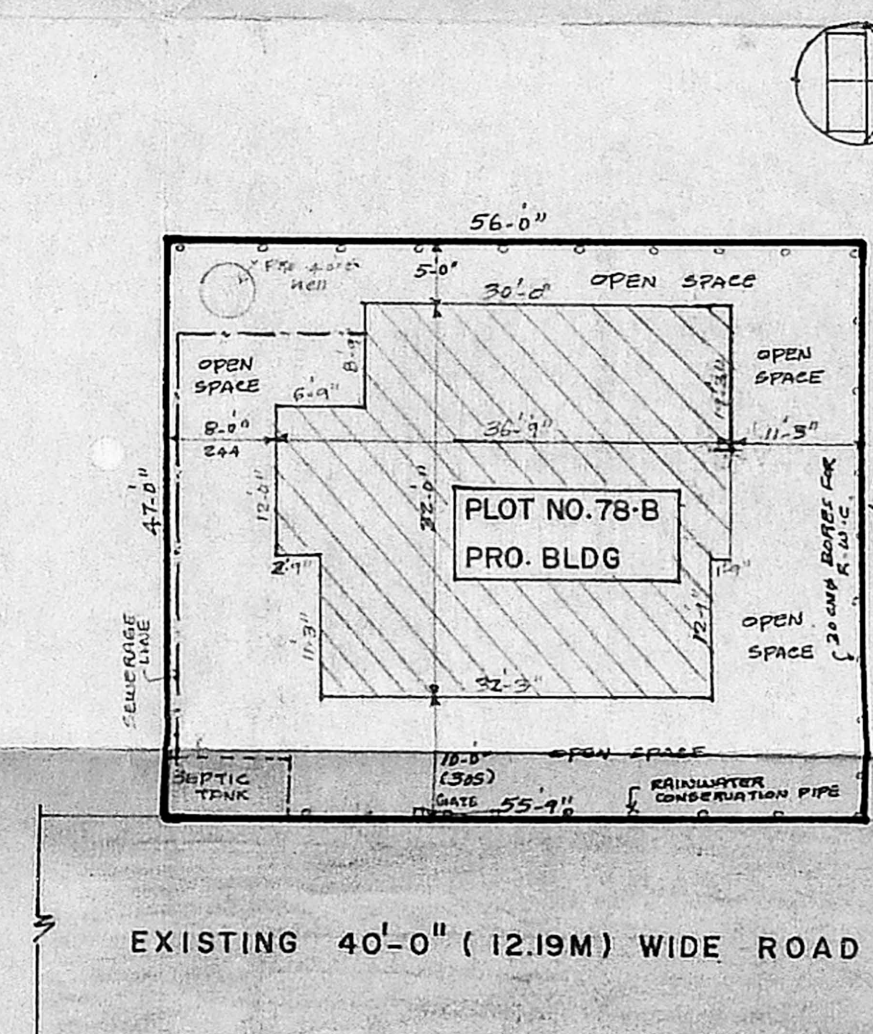

SITE PLAN (1"=16'-0" (or) 1:200)

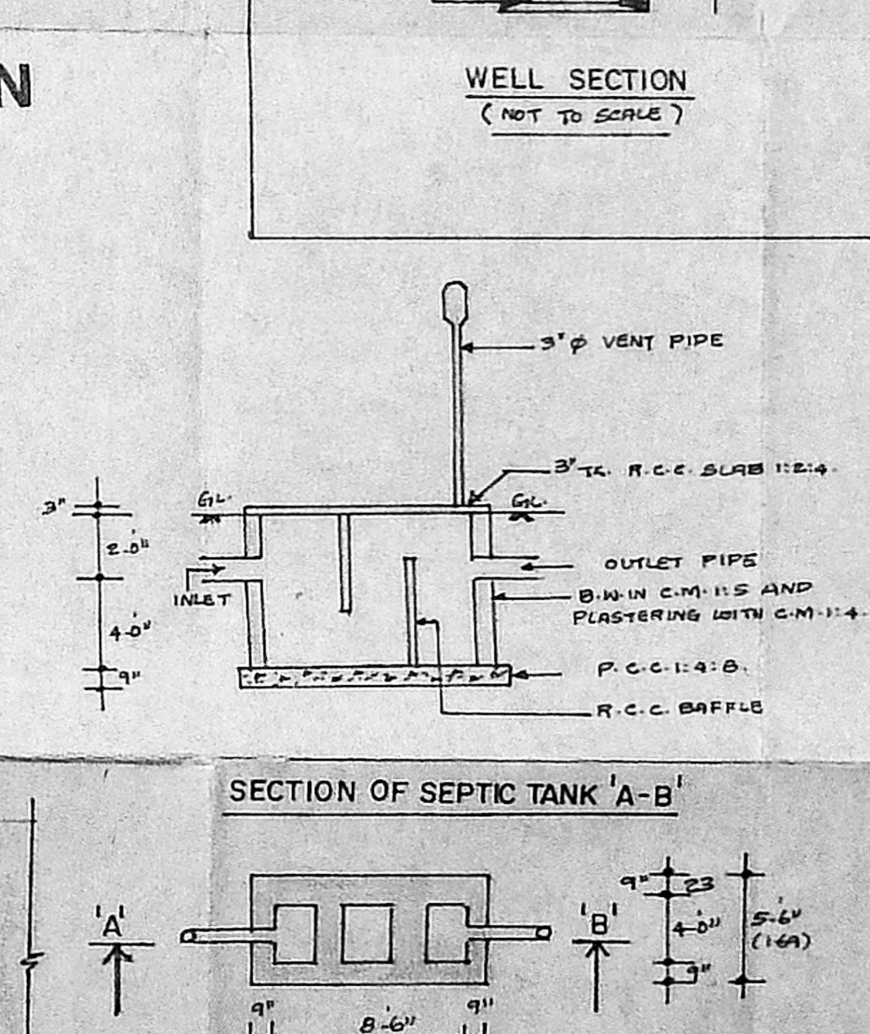

SECTION OF SEPTIC TANK 'A-B'

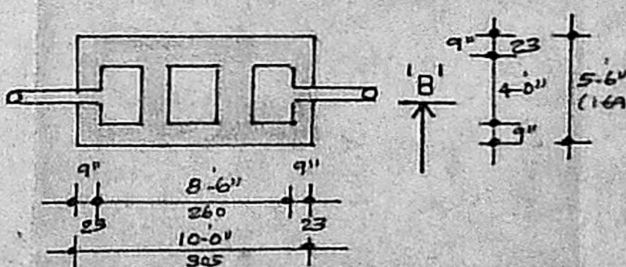

PLAN
DETAILS OF SEPTIC TANK

(NOT TO SCALE)

PLAN SHOWING THE PROPOSED CONSTRUCTION OF
 RESIDENTIAL BUILDING AT PLOT NO. 78-B,
 S.NO. 636(Part) IN SRI KAMAKOTTI NAGAR,
 PALLIKARANAI VILLAGE, SAIDAPET TALUK,
 CHENGAI M.G.R. DISTRICT. *scrutiny plan*
 A/14756/96
 H. 19/3

SPECIFICATIONS

- FOUNDATION : CEMENT CONC. 1:5:10 MIX WITH 40MM. METH. OVER SAND BED BRICK MASONRY FOOTINGS IN C.M. 1:6, MIX R.C.C. 1:2:4, PLINTH BEAM.
- FLOORING : STONE JELLY CEMENT CONC. 1:5:10, MIX 10 CM. THICK TOP FENDERED WITH C.M. 1:5, MIX 20MM. THICK.
- SUPER STRUCTURE : SPANNED BY R.C.C. LINTELS.
- ROOFING : R.C.C. ROOF SLAB 1:2:4, 11CM. THICK WITH NECESSARY WEATHERING COURSE ABOVE.

JOINERY DETAILS

- D - TEAK WOOD DOOR 3'-3" x 7'-0" (100 x 213)
- D1 - C.W. DOOR 3'-0" x 7'-0" (91 x 213)
- D2 - C.W. DOOR 2'-6" x 6'-6" (76 x 198)
- W - C.W. GLAZED WINDOW 4'-0" x 4'-6" (122 x 137)
- W1 - C.W. GLAZED WINDOW 3'-0" x 4'-6" (91 x 137)
- V - VENTILATOR 3'-0" x 1'-6" (91 x 46)
- J - R.C.C. JOLLY 6'-0" x 4'-6" (183 x 137)
- FW - FRENCH WINDOW 6'-0" x 6'-0" (183 x 183)

SCALE : 1" = 8'-0" (or) 1:100

COLOUR INDEX

- PROPOSED
- ROADS
- SITE BOUNDARY
- SEWERAGE LINE

AREA OF THE PLOT :	2632 Sq.ft.	244.51 Sq. m.
PRO. GROUND FLOOR	1064 Sq.ft.	98.85 Sq. m.
PRO. FIRST FLOOR	1064 "	98.85 "
PRO. HEAD ROOM	112 "	10.40 "
TOTAL	2240 Sq.ft.	208.10 Sq. m.

PLOT COVERAGE : 40%
 FLOOR SPACE INDEX : 0.80 TIMES

OWNER (V. MANICKAM)

From: K1793
N. P. CHANDRASEKARAN, DCE,
 CIVIL ENGINEER & BUILDING CONTROL OFFICER,
 LICENCED SURVEYOR NO. 1169,
 CORPORATION OF MADRAS,
 NO. 15B, BIG STREET,
 LICENSURE, MADRAS - 600 008.

LICENSSED SURVEYOR.